



MARTÍN MENA[®]
DESIGNED AND MANUFACTURED IN SPAIN (EU)

PRESTO 31811

CHARACTERISTICS

Material

The brass used in the fabrication of our taps complies standards EN-12164, EN-12165 and EN-1982.

Treatment and outside

Nickel- and Chrome-plated according to the standard EN-248.

Saline-mist resistance equal to 200 hours, according to the standard ISO-9227.

Permissible water temperatura

Improving health regulations, the component materials of the tap's parts can tolerate a temperatura going until 70 degrees.

- Body and button made of Chrome-plated brass, interior parts made of corrosionresistant materials to the bild-up of calcium.
- Interchangeable head containing all the mechanism of the tap.
- Input Male $\frac{1}{2}$ and exit female.
- Flow rate: 6 l/min.
- Automatic closing: 15 +/- 5 sec.
- Stainless steel screws.
- Gross Weight: 0,470 kg.

MODELS

- Ref. 31811

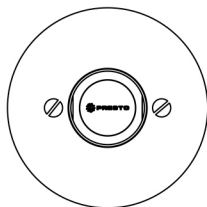
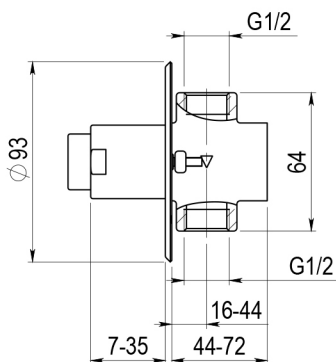

STANDARD

- Certificate ISO 9001.
- Optimizations of dimensioning, water-resistance and hydraulic tests. According to the CTE.
- Design according to the European Standard of Time Taps EN 816.